



SUISSEMED
INTEGRATED HEALTHCARE SOLUTIONS

Focus on Emergency



DESCRIPTION OF THE MODULAR BUILDING

The Healthcare units are realized through modular buildings, to be placed next to the existing hospitals and in continuity with them, in order to focus on the COVID medical emergency as soon as possible and to support, in an integrated way, the existing healthcare facilities, either during the acute phase of the disease and during the post-disease/recovery phase.

The " Independent Covid Hospital Configuration" is a health facility arranged into the following Units:

MAIN FUNCTIONS:

- n.1 Module Intensive Care Unit (ICU) with 16 beds
- n.4 Module for Sub-intensive Care Unit and Covid Unit wards with n.88 beds up to n. 100 beds (50% n. 44 Sub-Intensive beds and 50% n. 44 beds for Covid beds already configured for intensive care unit)

SUPPORT FUNCTIONS:

- n.1 Module for Pulmonary Rehabilitation Unit
- n.1 Module for Imaging and Treatment Unit (including surgery facility)
- n.1 Module for Acceptance, medical examination and Observation (12 observation beds)
- n.1 Module for Staff changing rooms, general service facilities, warehouse

The flexibility of the project allows to provide a facility with a greater or less number of beds, with several configurations of units (ICU, Sub Intensive, Covid beds), or to add or remove other wards. The facilities are made of modules that can be dismantled / relocated in other areas at the end of the emergency or reconfigurable to stay as permanent facilities.





INDEPENDENT COVID CONFIGURATION

The "Masterplan" portrayed on the right, represents a **full study**, that foresees all **The Functions and Facilities** necessary to support the existing hospitals, with Functional solutions and systems according to the context of the area.

The healthcare solution will be arranged in "Modules" :

- **Acceptance Module**, 1 Module for Acceptance, medical examination and Observation Beds (n. 12)
- **Intensive Care Module (ICU)**, 1 Module with 16 beds
- **Imaging and Surgery** 1 Module (next to and connected to the ICU), 1 Operating Room with Sterilization area and 1 CT Scan area
- **Sub- Intensive and Covid wards Modules**, 4 Module with 22 beds per unit (up to 25 beds)
- **Pulmonary Rehabilitation Module**, 1 Module for "outpatients"
- **General Services** 1 Module (medical offices, meeting room, staff locker rooms)
- **General Warehouses** 1 Module
- **Mechanical and Electrical Plantroom**

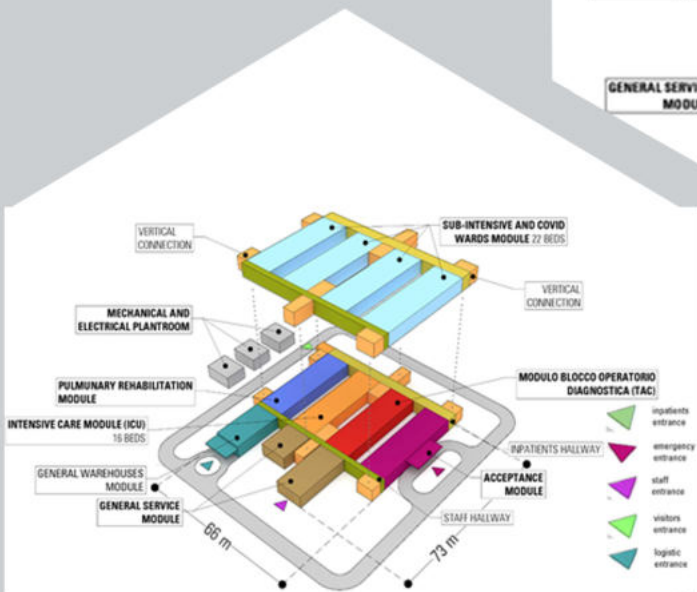
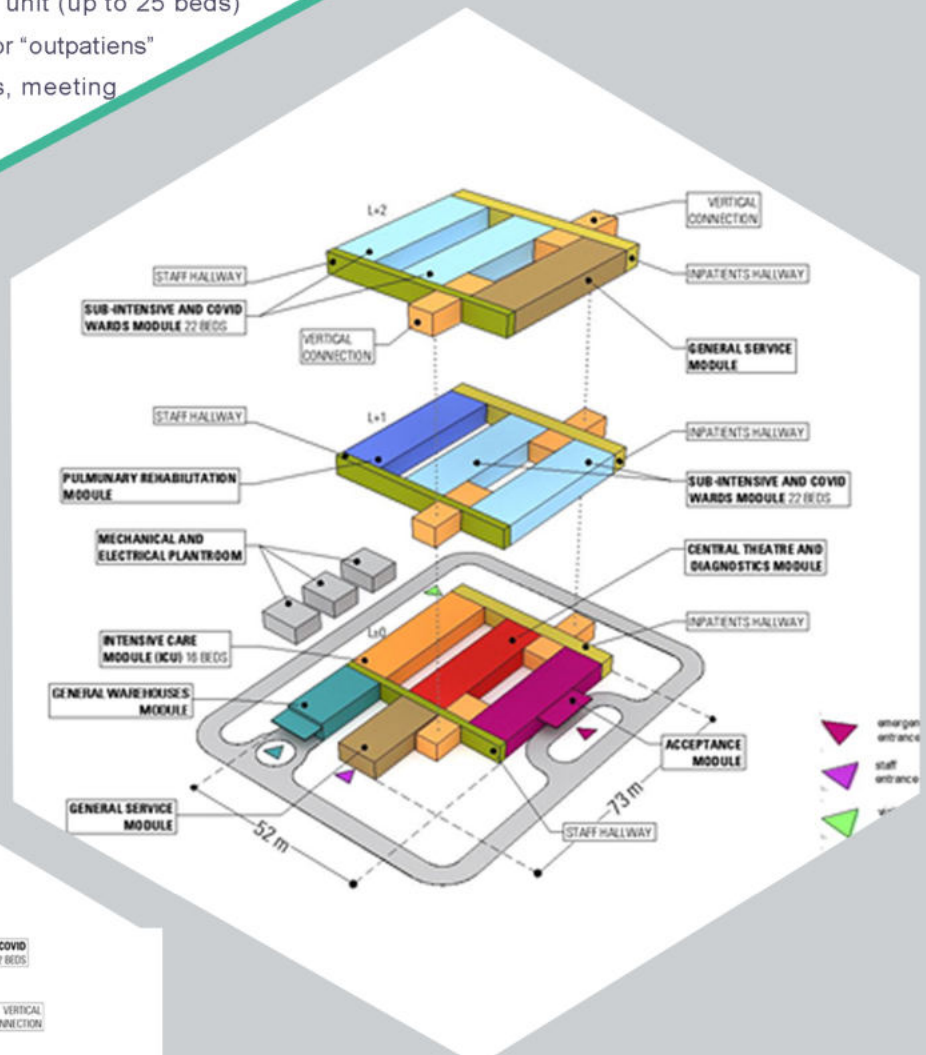

"INDIPENDENT COVID " FACILITY CONFIGURATION			
	Total	Intensive Care	Sub-intensive Care COVID-19 Hospital stay
Modules	5	1	4
N°. beds	116	16	44/50
m ² /bed	21 m ²		
Area			
ADDITIONAL AREA AROUND 2.100 m ²	ADDITIONAL MODULES FOR "INDIPENDENT COVID " FACILITY CONFIGURATION		
	Imaging and Treatment Unit		Lockers room,general services facilities
	Pulmonary Rehabilitation Unit		Acceptance, medical examination and observation (12 observ. Beds)
	Warehouse		

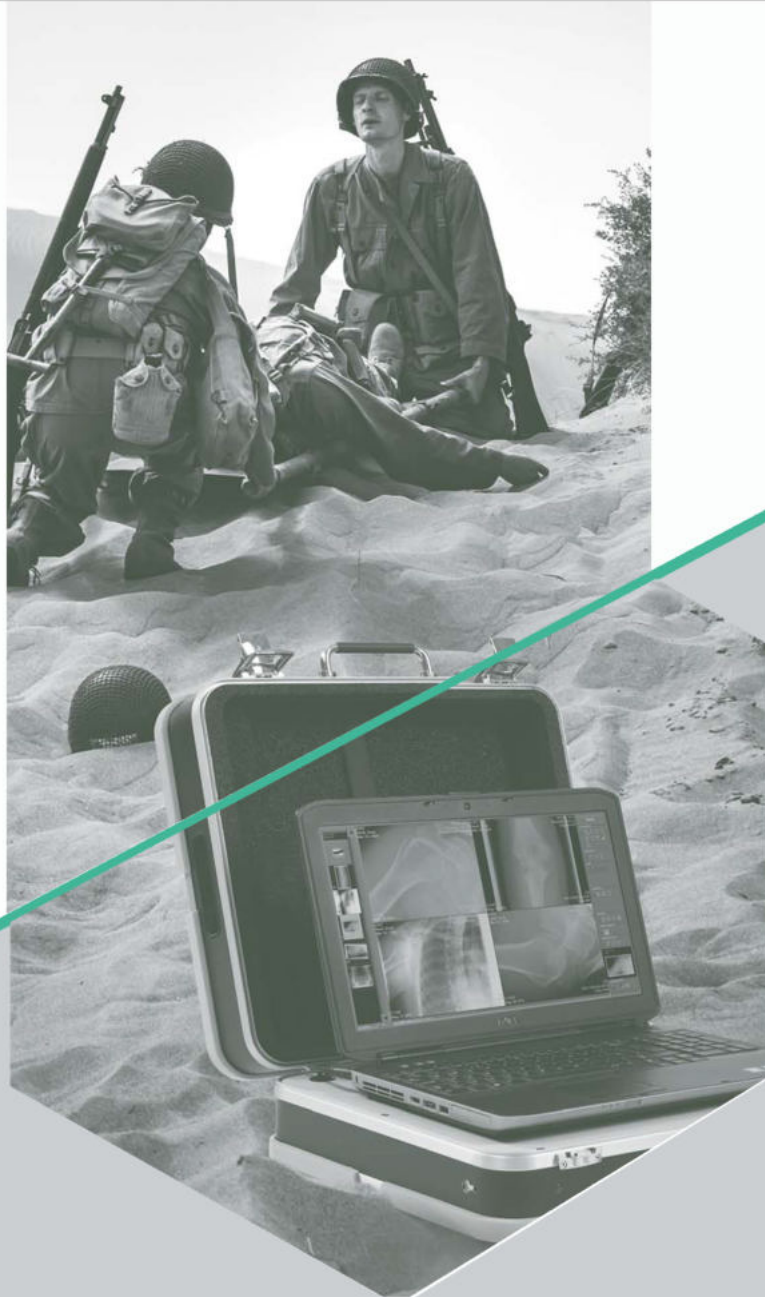



SUISSEMED
INTEGRATED HEALTHCARE SOLUTIONS

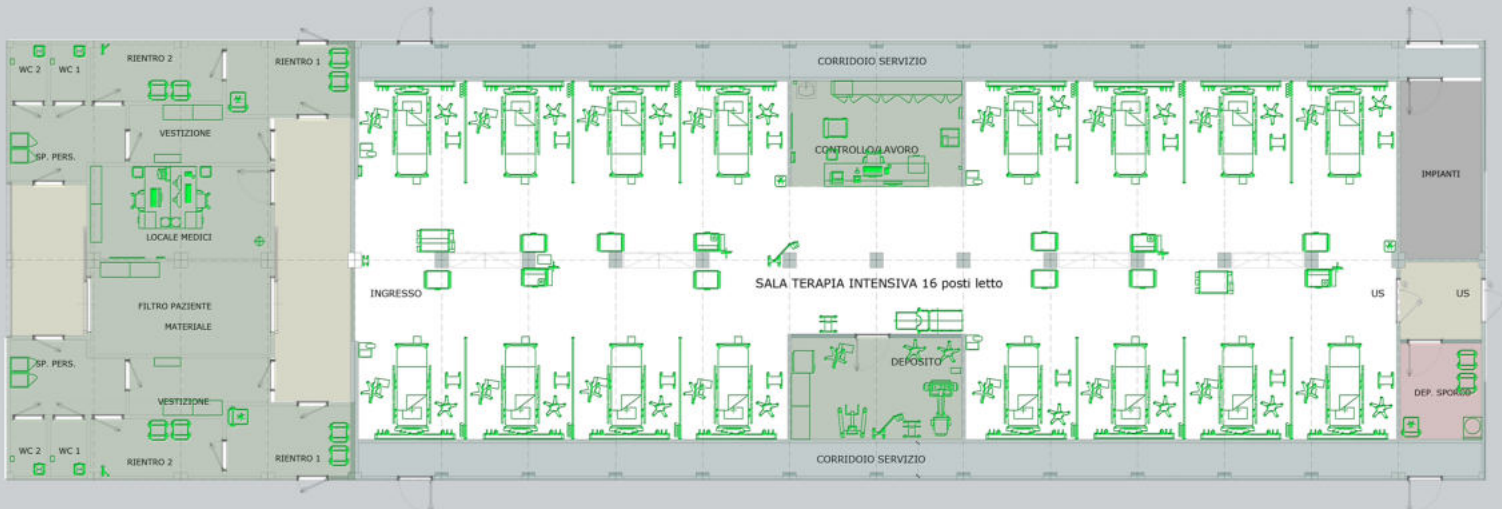
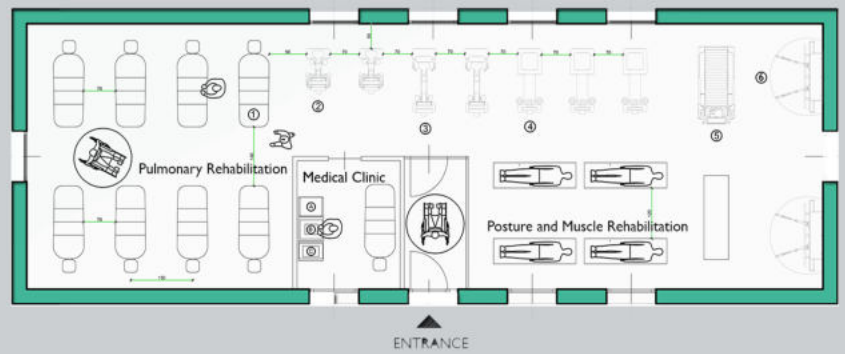





SUISSEMED

INTEGRATED HEALTHCARE SOLUTIONS

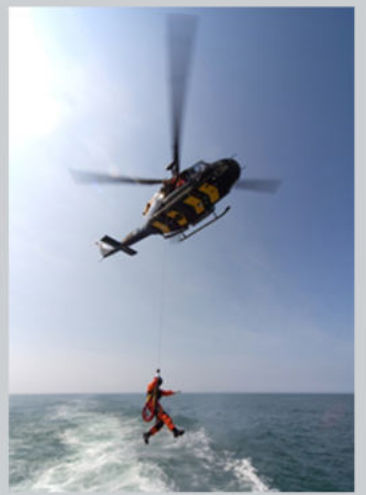



Suisseméd - Integrated Healthcare Solutions

Via a La Mogina, 2, 6535 Roveredo (CH)

Tel. +41.91.8350037 Fax. +41.91.8271805

www.suisseméd-ihs.com procurement@suisseméd-ihs.com

Info hotline : +41 91 8350037

